

4

3

2

1

NOTES:

GENERAL NOTES

- 1.1 ALL METRIC DIMENSIONS ARE IN BRACKETS
- 1.2 FEATURES CRITICAL TO QUALITY ARE INDICATED IN ROUNDED BOX (X.X)
- 1. DESIGN NOTES
- 2. MANUFACTURING/SPECIAL REQUIREMENTS
- 3. TEST
- 4. PACKAGING
  - 5.1 PLACE ALL ITEMS IN A BOX
  - 5.2 PACKAGE HARDWARE USING THE PROVIDED POLYBAG
  - 5.3 REFERENCE DOCUMENT PACK-860661736-MV2-C01X FOR PACKAGING REQUIREMENT

REVISIONS				
REV.	ECN	DESCRIPTION	BY	DATE
B	13932	INITIAL RELEASE	TN1010	07/15/2021

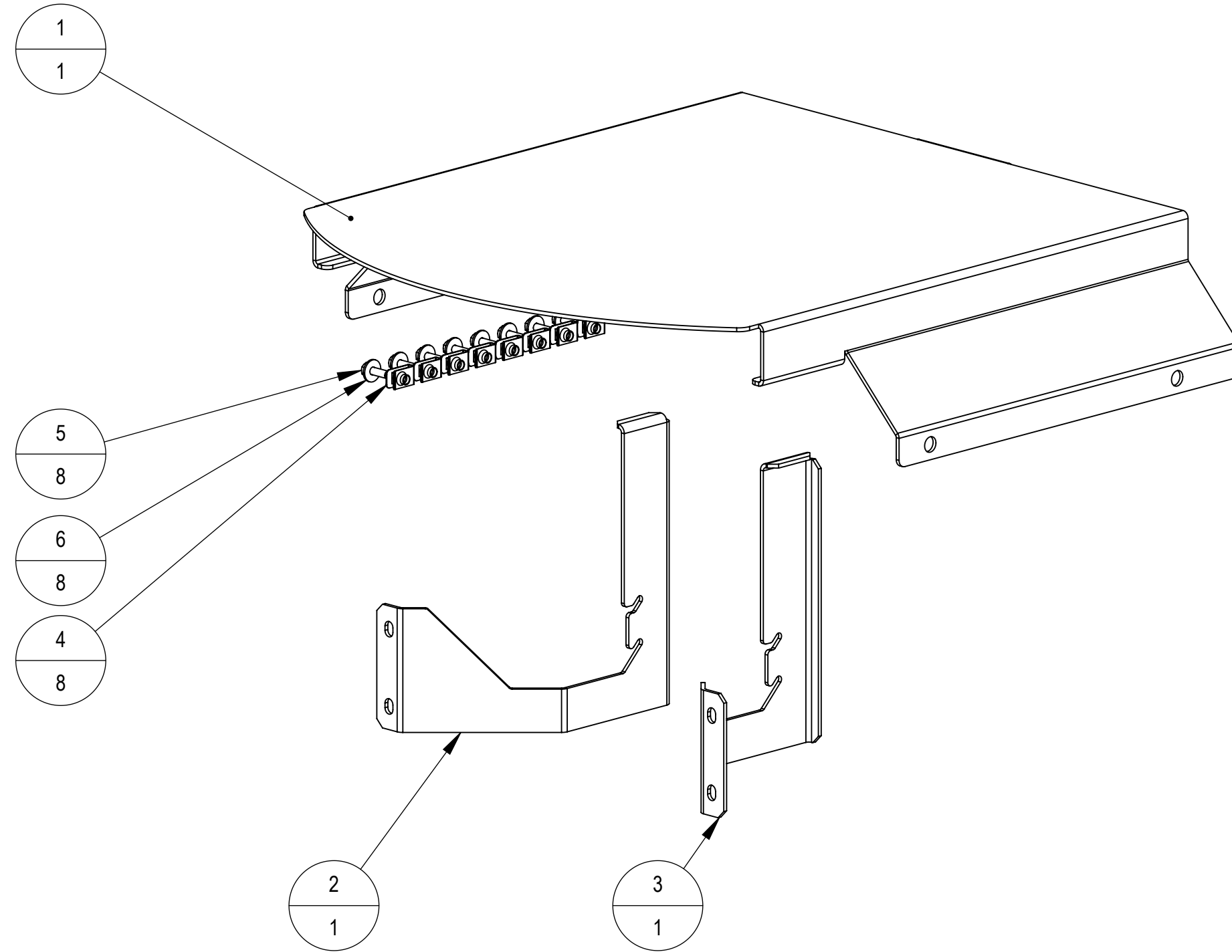

ITEM NO.	PART NUMBER	DESCRIPTION	QTY.	NOTES
1	MTM1117-1300-XX	COVER,SOLAR,MV2	1	
2	MTM1117-5801	PLATE,HANG,SPLITTER-R,MV2	1	
3	MTM1117-5802	PLATE,HANG,SPLITTER-L,MV2	1	
4	460143456	CLIP NUT, M6, 316 SST	8	5.2
5	100534-214	HEX HD CAP SCREW, M6-1 X 20mm, SST, PASS	8	5.2
6	100525-71	WSHR,FLAT,M6,6.4X18X1.6,SST,PASS	8	5.2
7	SWL-M6	M6 LOCK WASHER SST	8	5.2
8	PB7	POLYBAG 4-MIL X 6" X 16" (EA)	4	

DENSITY		lbs/in <sup>3</sup>
MASS	23.32	lbs
VOLUME	89.74	in <sup>3</sup>
SURFACE AREA	1489.04	in <sup>2</sup>
HEIGHT		
LENGTH		
WIDTH		

<b>COMMSCOPE, INC. OF NORTH CAROLINA</b>										
TOLERANCES 1 PLACE .X ± SEE NOTE 1 3 PLACE .XXX ± 2 PLACE .XX ± ANGLES ±					SAP MATERIAL MASTER <b>860661736-MV2-C01X</b>					
FINISH NONE					MATERIAL SEE STOCKLIST					
UNLESS OTHERWISE SPECIFIED DIMENSIONS ARE IN INCHES INTERPRET PER ANSI Y 14.5M-1994	CE	YMENG	05/21/2021	MV2,RETRO,EPA,001						
	RW	HDAI	08/18/2021							
	AD	PX1012	08/18/2021							
	RE	HDAI	08/18/2021							
	ECN 13932PC			SCALE	DOCUMENT NO.					
			1:8	860661736-MV2-C01X						
SIZE	Auth Group	INSL	MODEL			DRAWING				SHEET
C			VERSION	STATUS	REVISION	VERSION	STATUS	REVISION	1 OF 1	
			00	RE	A	00	RE	B		