

## 860252485-M001-INSTALL INSTALLATION INSTRUCTION

ENCLOSURE, HCRE V2, 70"

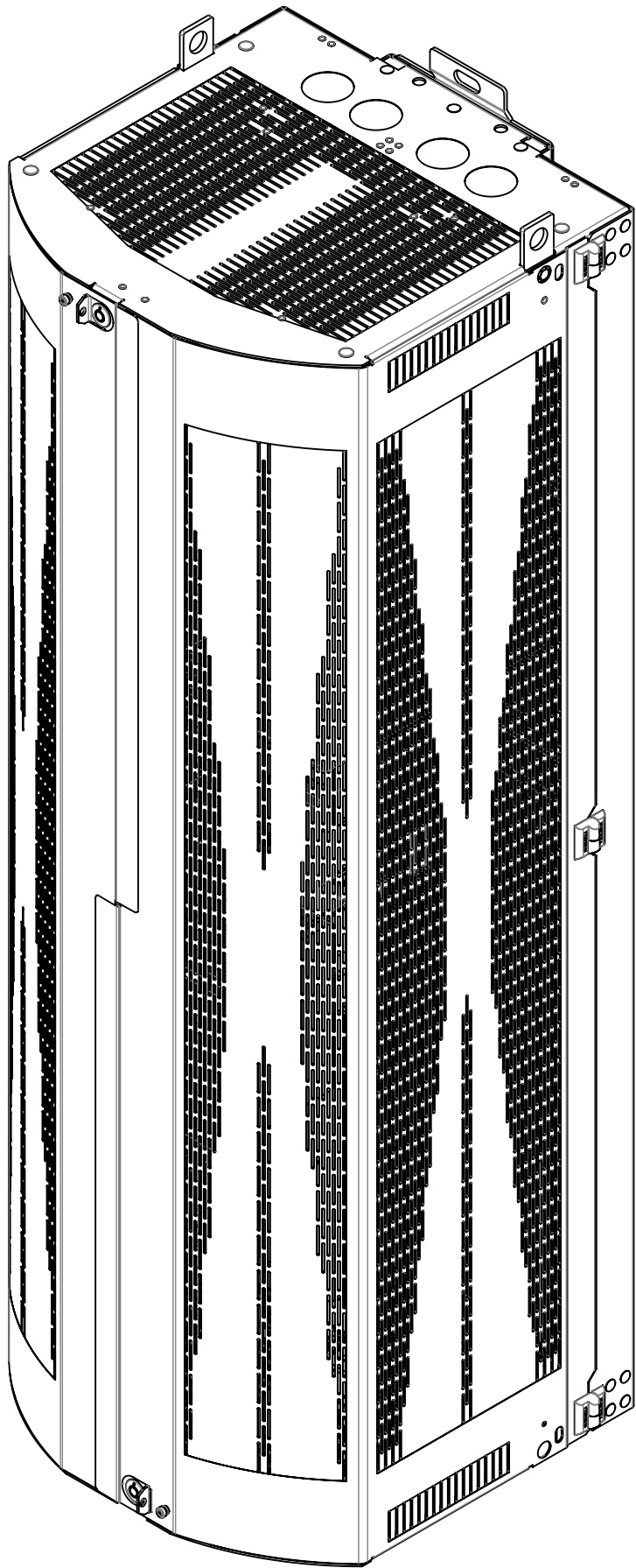

REVISIONS			
REV.	DESCRIPTION	DATE	APPROVED
A	INITIAL RELEASE	MS1288 11FEB25	LX1002 50101331AMO
B	UPDATED VIEWS FOR SHEET 4	MS1288 14MAR25	LX1002 50101900AMO

This table show the evolution and history of document from initial to current version.

Further information regarding CommScope's commitment can be found at [www.commscope.com/About-Us/Corporate-Responsibility-and-Sustainability](http://www.commscope.com/About-Us/Corporate-Responsibility-and-Sustainability).  
Visit our website or contact your local CommScope representative for more information.  
This product is covered by one or more U.S. patents or their foreign equivalents. For patents, see [www.adwpat.com](http://www.adwpat.com)

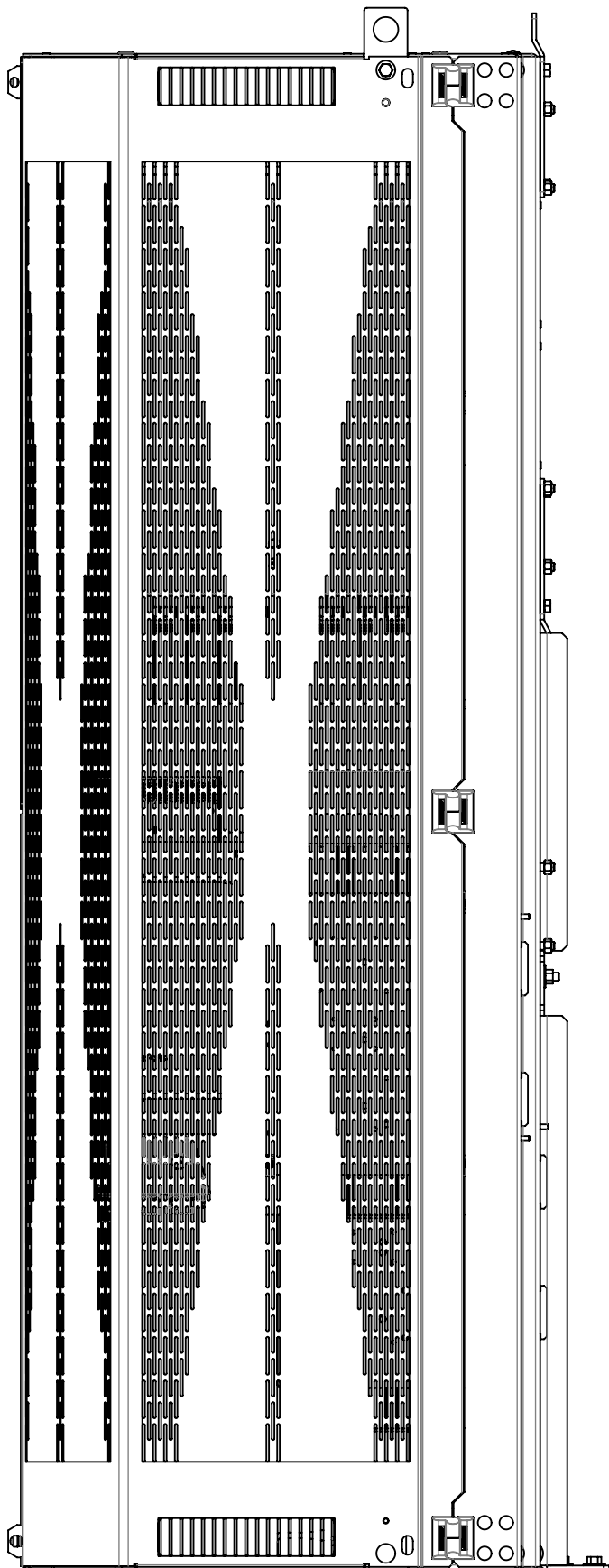
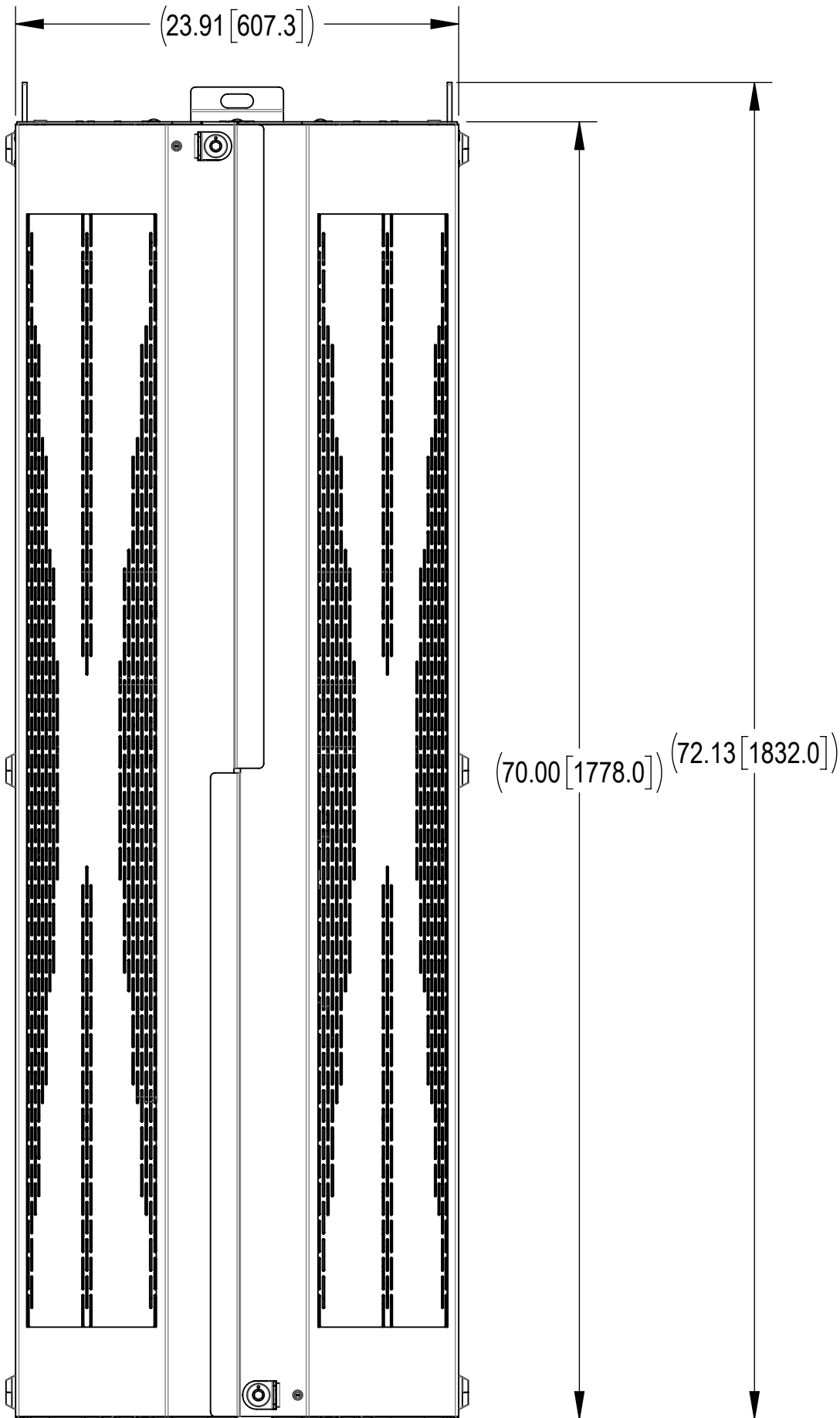
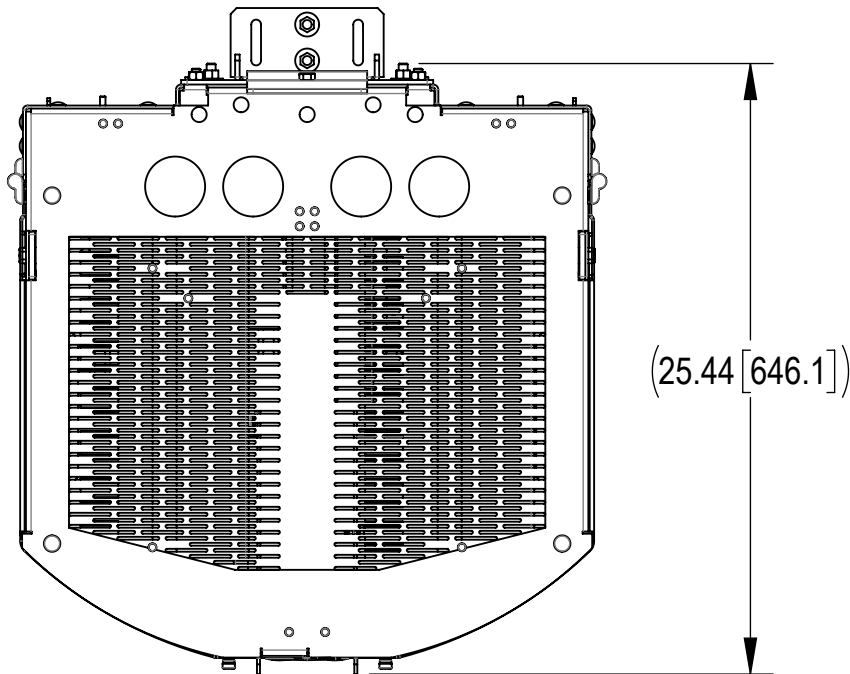

# Installation Instructions



- 1.0 GENERAL NOTES
- 1.1 ALL METRIC DIMENSIONS ARE IN BRACKETS [X.X]
- 2.0 DESIGN NOTES
- 3.0 MANUFACTURING/SPECIAL REQUIREMENTS
- 3.1 TIGHTEN HARDWARE, TORQUE VALUE ARE SHOWN BELOW AS REFERENCE,  
M6: TORQUE 40.0 IN-LB OR 4.5 N-M (W/ CLIP NUT)  
M6: TORQUE 46.0 IN-LB OR 5.2 N-M (W/ THREADED CAST AL)  
M6: TORQUE 75.0 IN-LB OR 8.5 N-M (W/ STEEL NUT)  
M8: TORQUE 6.6 FT-LB OR 9.0 N-M (W/ THREADED CAST AL)  
3/8-16: TORQUE 19.6 FT-LB OR 26.6 N-M
- 4.0 TEST
- 5.0 PACKAGING
- 5.1 THIS PRINTED DOCUMENT TO BE PLACED INSIDE SHIPPING BOX FOR CUSTOMER INSTALLATION

CONFIGURATION	APPROVED RADIO CONFIGURATIONS					
	4490	4890	220x or 440x	COMMSCOPE DOWN CONVERTER DPCPWR-NODE-1500	EFORE DC-AC INVERTER MIMMI	CHARLES CFTT4 FIBER BOX
1	1	1	1	4	1	1

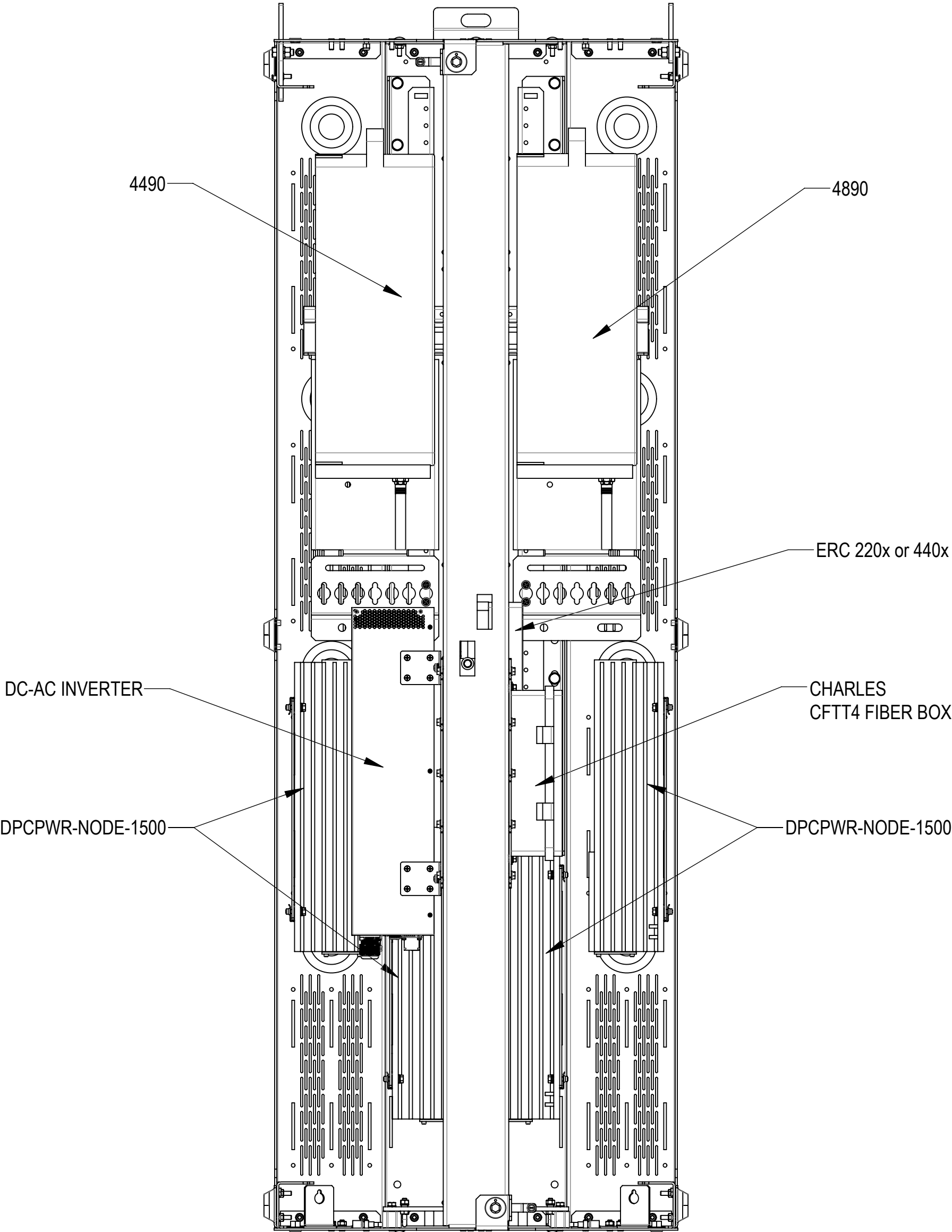

FRONT VIEW  
(DOORS REMOVED)

- 1.0 GENERAL NOTES
- 1.1 ALL METRIC DIMENSIONS ARE IN BRACKETS [X.X]
- 2.0 DESIGN NOTES
- 3.0 MANUFACTURING/SPECIAL REQUIREMENTS
- 3.1 TIGHTEN HARDWARE, TORQUE VALUE ARE SHOWN BELOW AS REFERENCE,  
M6: TORQUE 40.0 IN-LB OR 4.5 N-M (W/ CLIP NUT)  
M6: TORQUE 46.0 IN-LB OR 5.2 N-M (W/ THREADED CAST AL)  
M6: TORQUE 75.0 IN-LB OR 8.5 N-M (W/ STEEL NUT)  
M8: TORQUE 6.6 FT-LB OR 9.0 N-M (W/ THREADED CAST AL)  
1/4-20: TORQUE 4.8 FT-LB OR 6.6 N-M  
3/8-16: TORQUE 19.6 FT-LB OR 26.6 N-M
- 4.0 TEST
- 5.0 PACKAGING
- 5.1 THIS PRINTED DOCUMENT TO BE PLACED INSIDE SHIPPING BOX FOR CUSTOMER INSTALLATION

EQUIPMENT MOUNTING INSTALLATION

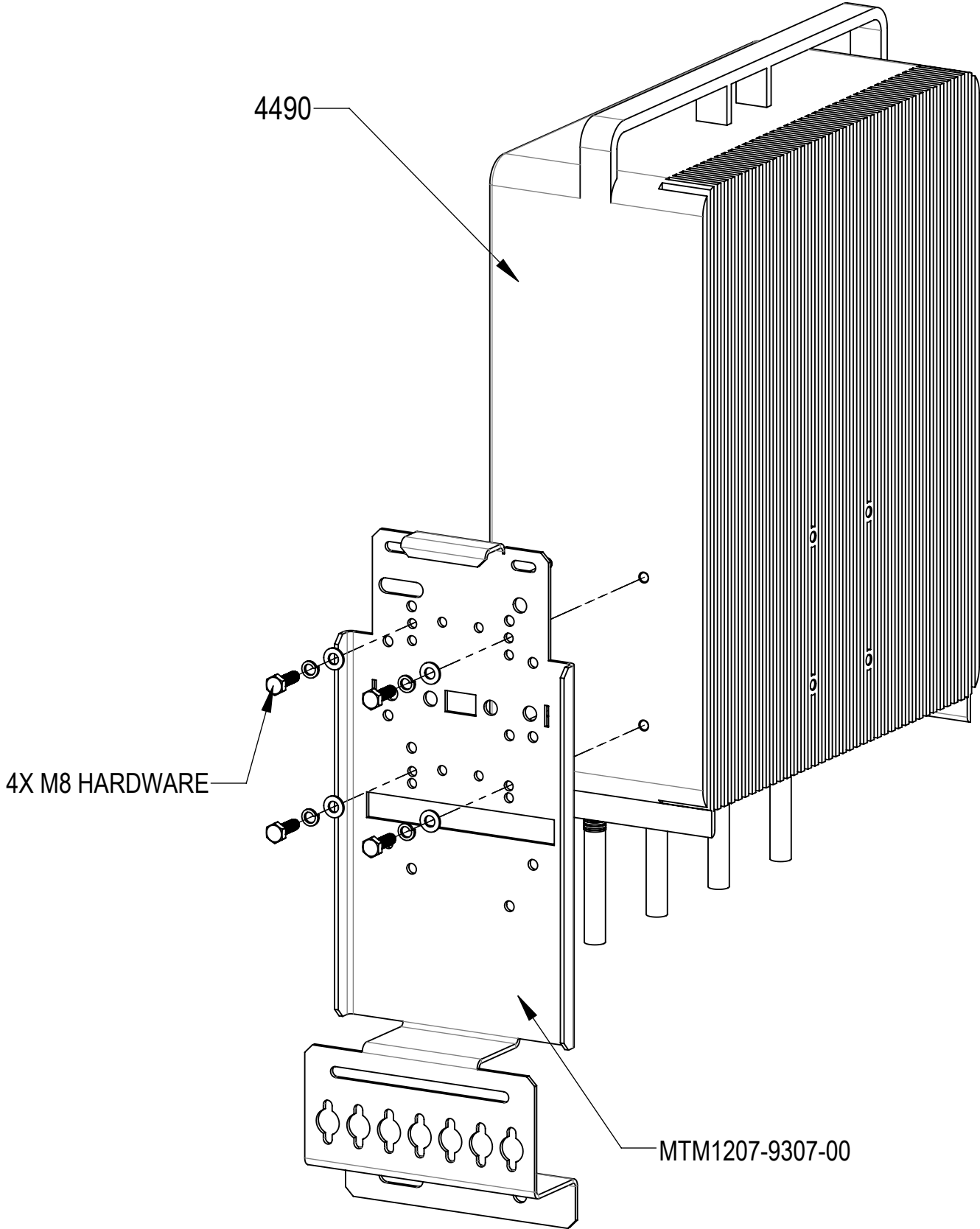

4490:

INSTALL 4490 TO THE BRACKET MTM1207-9307-00 USING 4 SETS OF M8 HEX BOLTS, M8 LOCK AND FLAT WASHERS AS SHOWN

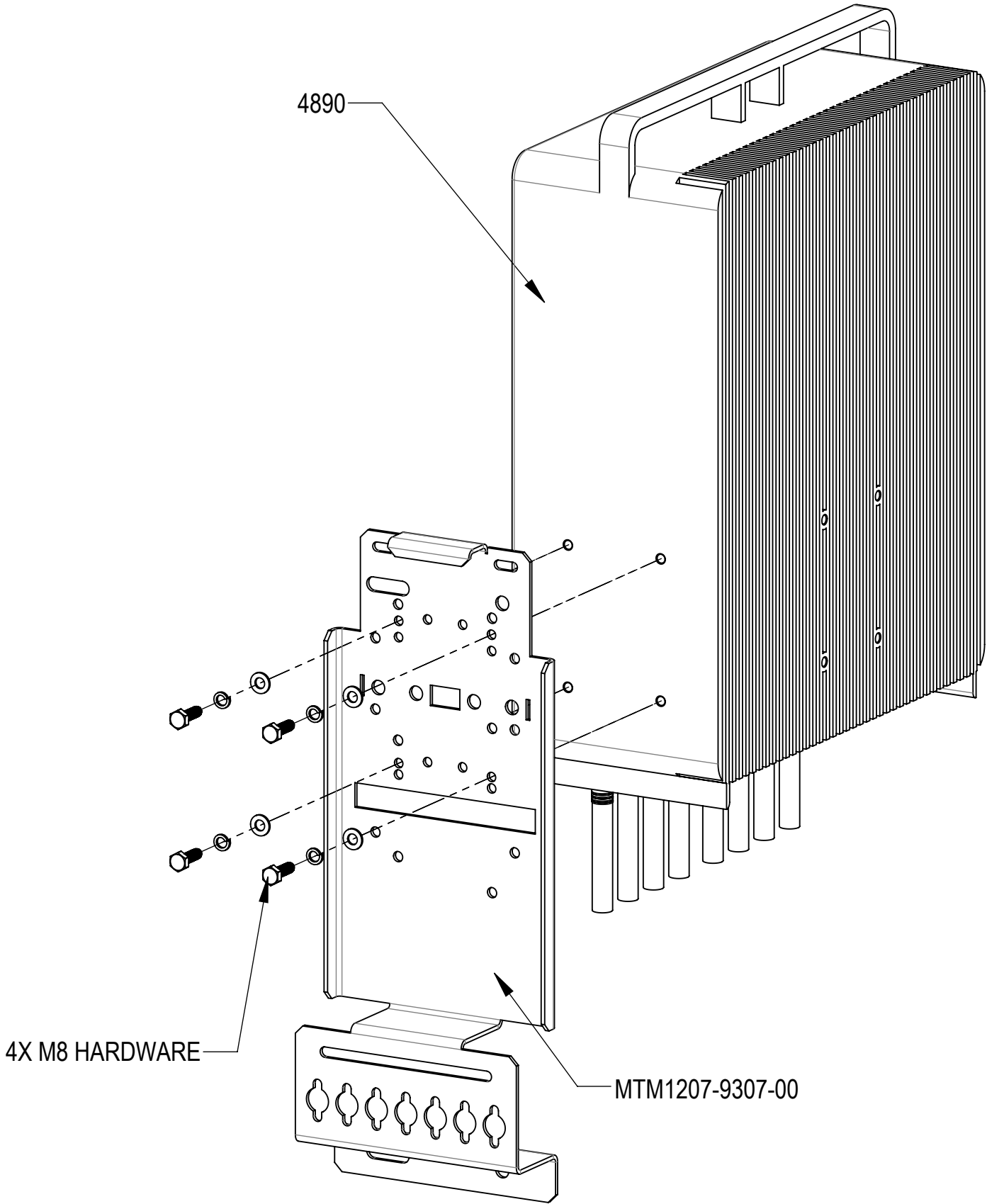

4890:

INSTALL 4890 TO THE BRACKET MTM1207-9307-00 USING 4 SETS OF M8 HEX BOLTS, M8 LOCK AND FLAT WASHERS AS SHOWN

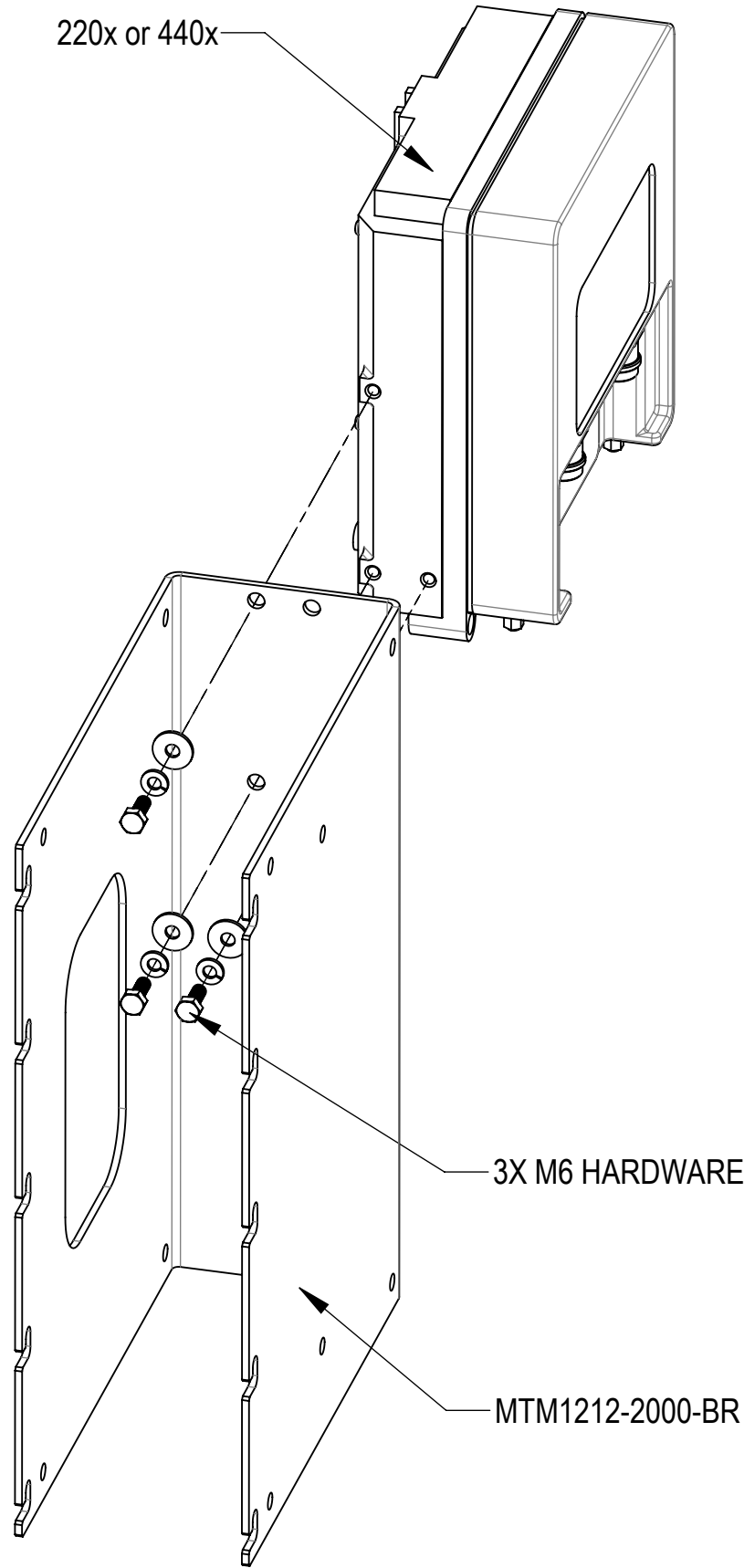

220x or 440x:

INSTALL 220x or 440x TO THE BRACKET MTM1212-2000-BR WITH 3 SETS OF M6 HEX BOLTS, M6 LOCK & FLAT WASHERS AS SHOWN.



# Installation Instructions

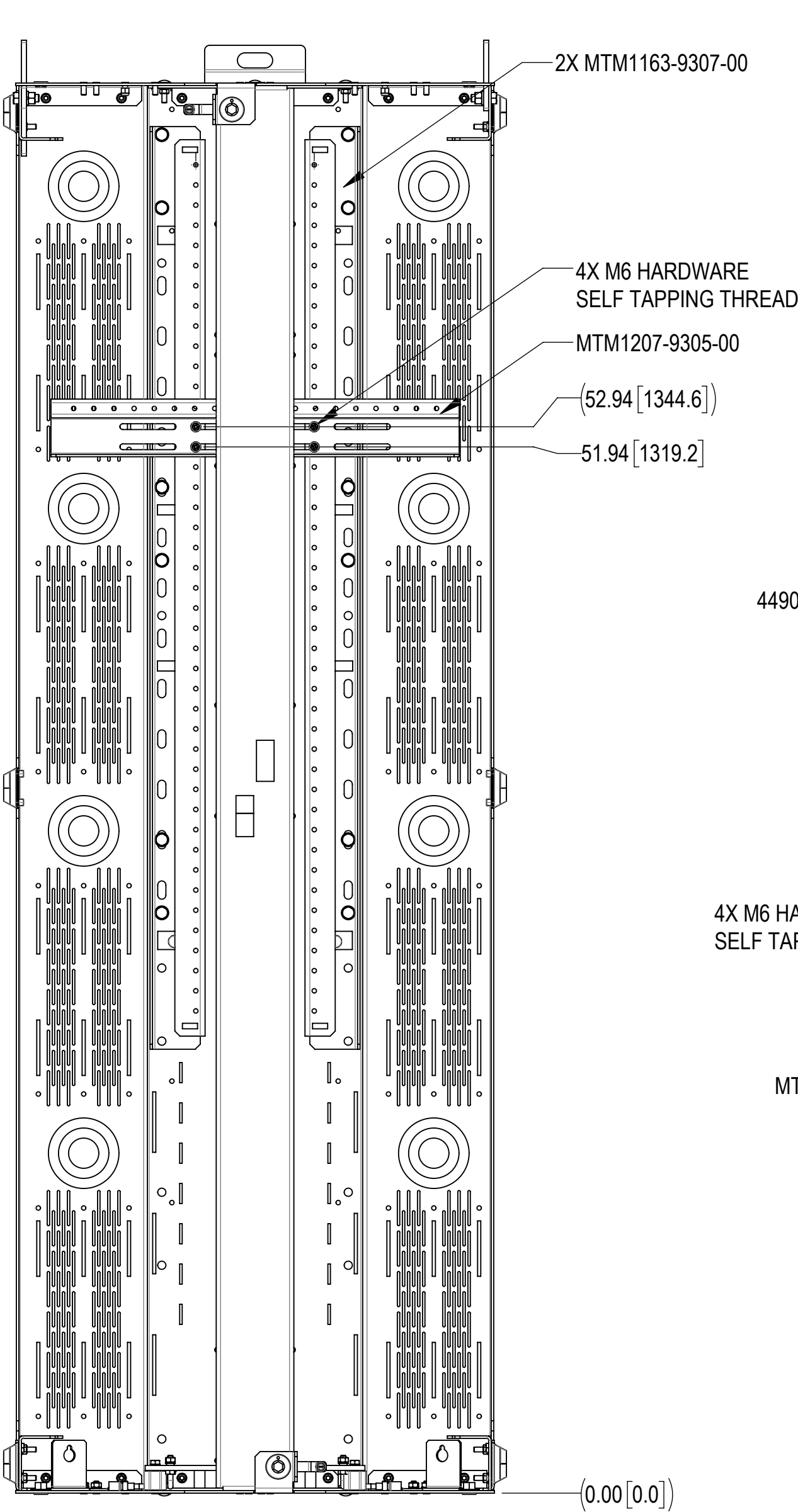

**STEP 1**  
INSTALL 1EA BRACKET MTM1207-9305-00 TO MTM1163-9307-00 USING 4 SETS OF M6 SCREWS (SELF TAPPING THREAD), TIGHTEN THEM DOWN AS SHOWN

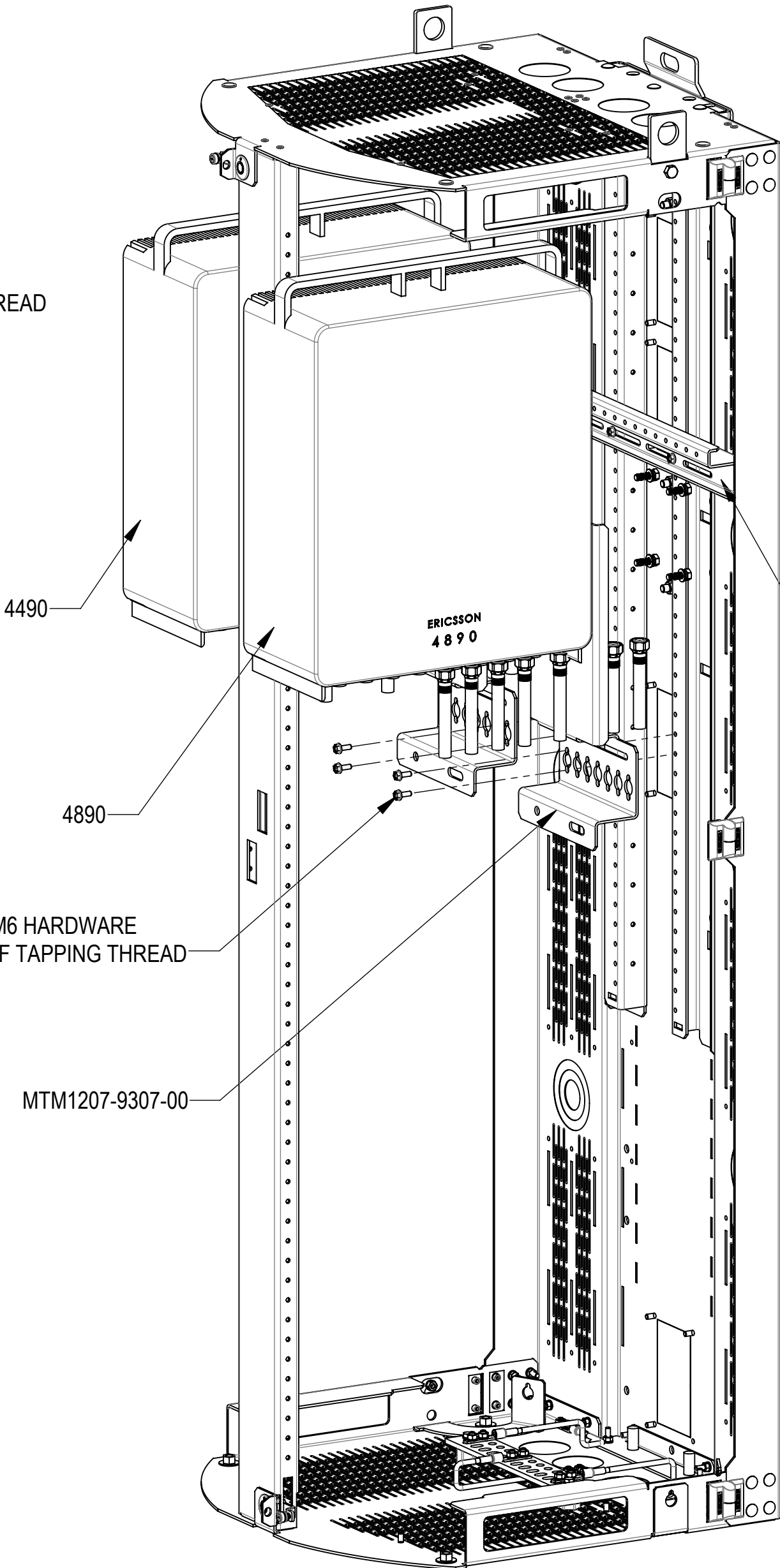

**STEP 2**  
HANG 4490 AND 4890 SUB-ASSEMBLY ON THE MTM1207-9305-00 AND SECURE BY 4 SETS OF M6 SCREWS (SELF TAPPING THREAD), TIGHTEN THEM DOWN AS SHOWN

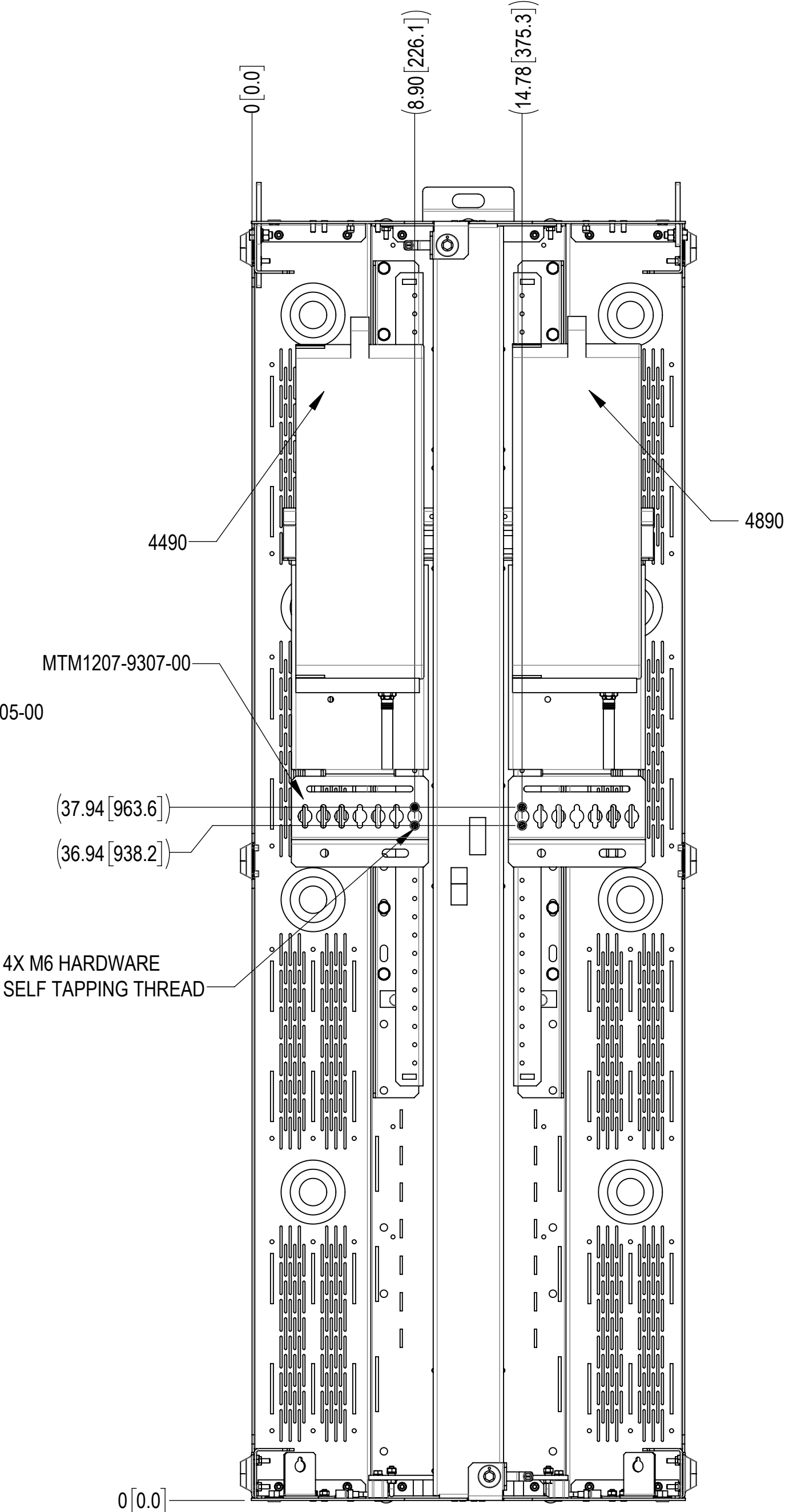

FRONT VIEW  
BRACKET MTM1207-9307-00 LOCATION SHOWN  
(DOORS NOT SHOWN)

# Installation Instructions

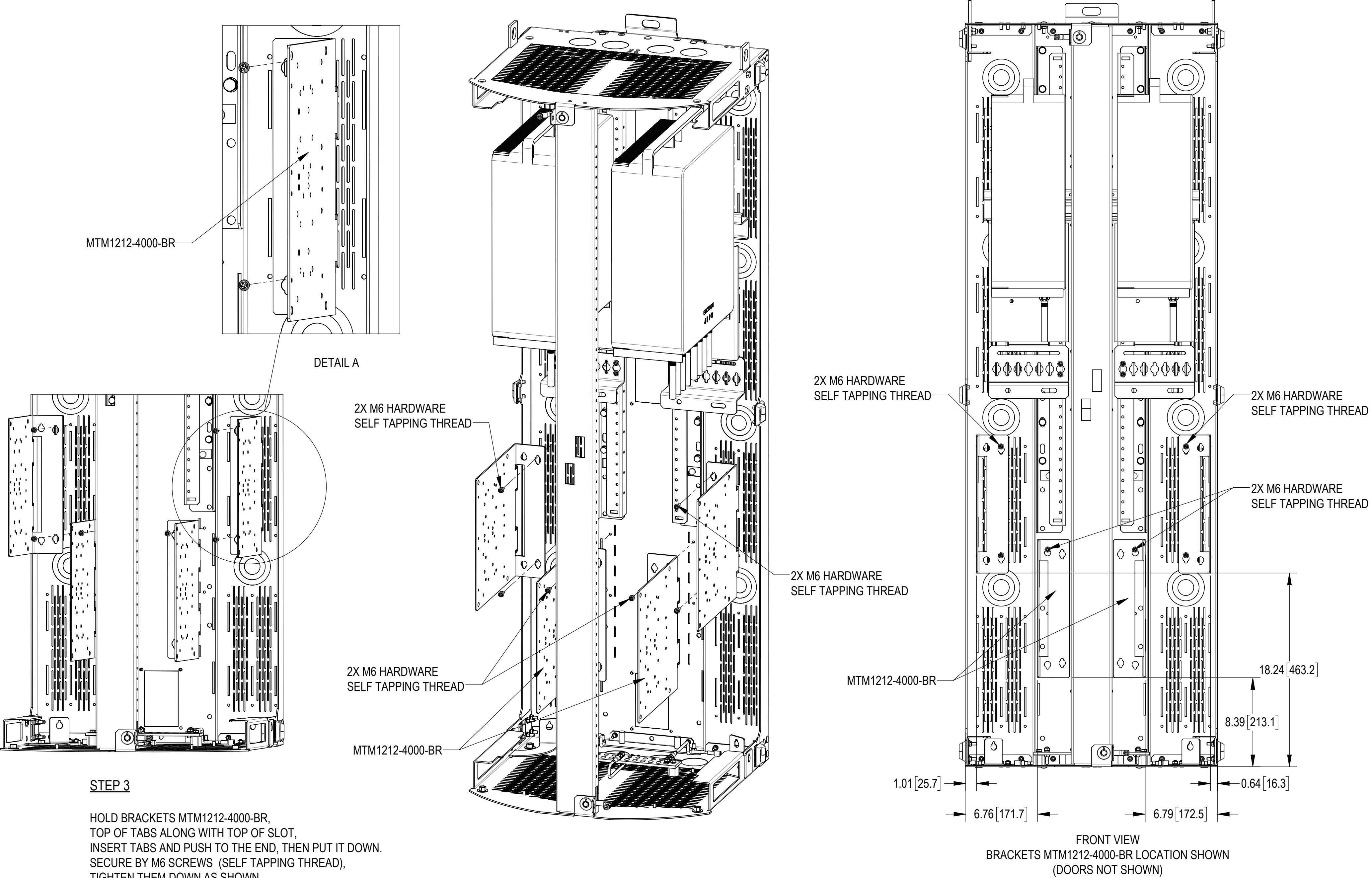

# Installation Instructions

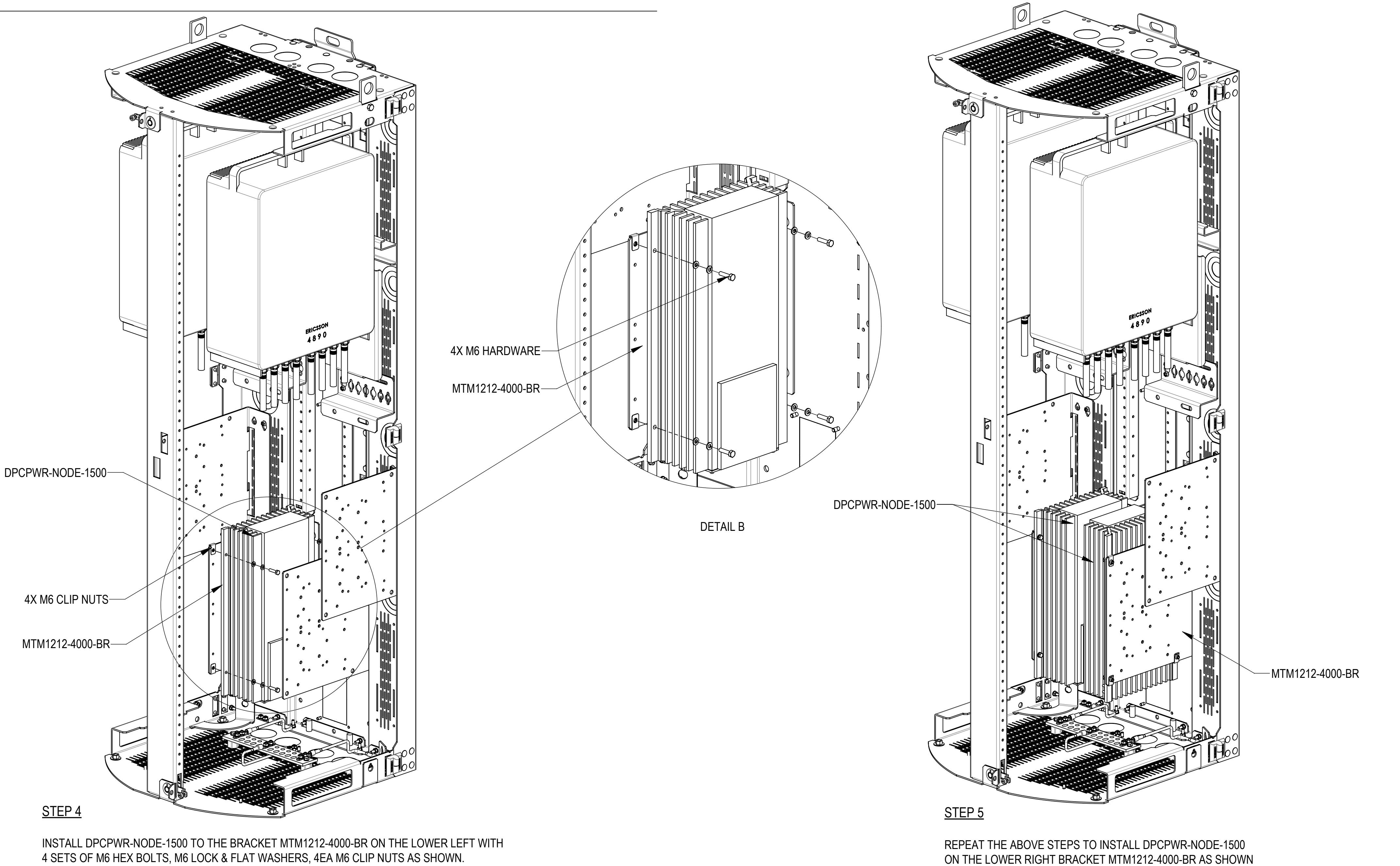



# Installation Instructions

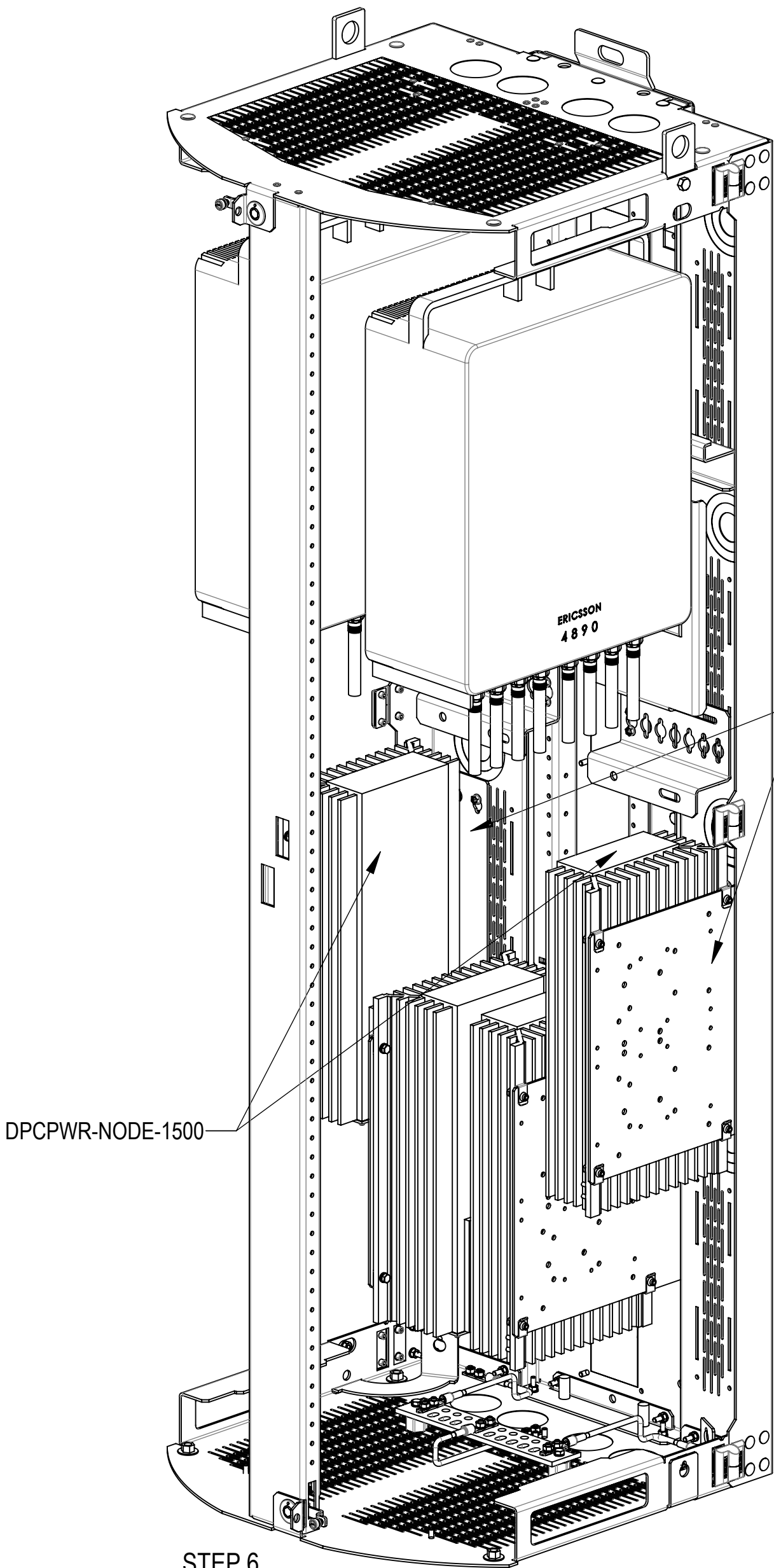

STEP 6

REPEAT THE ABOVE STEPS TO INSTALL 2EA DPCWR-NODE-1500 ON THE UPPER BRACKETS MTM1212-4000-BR AS SHOWN

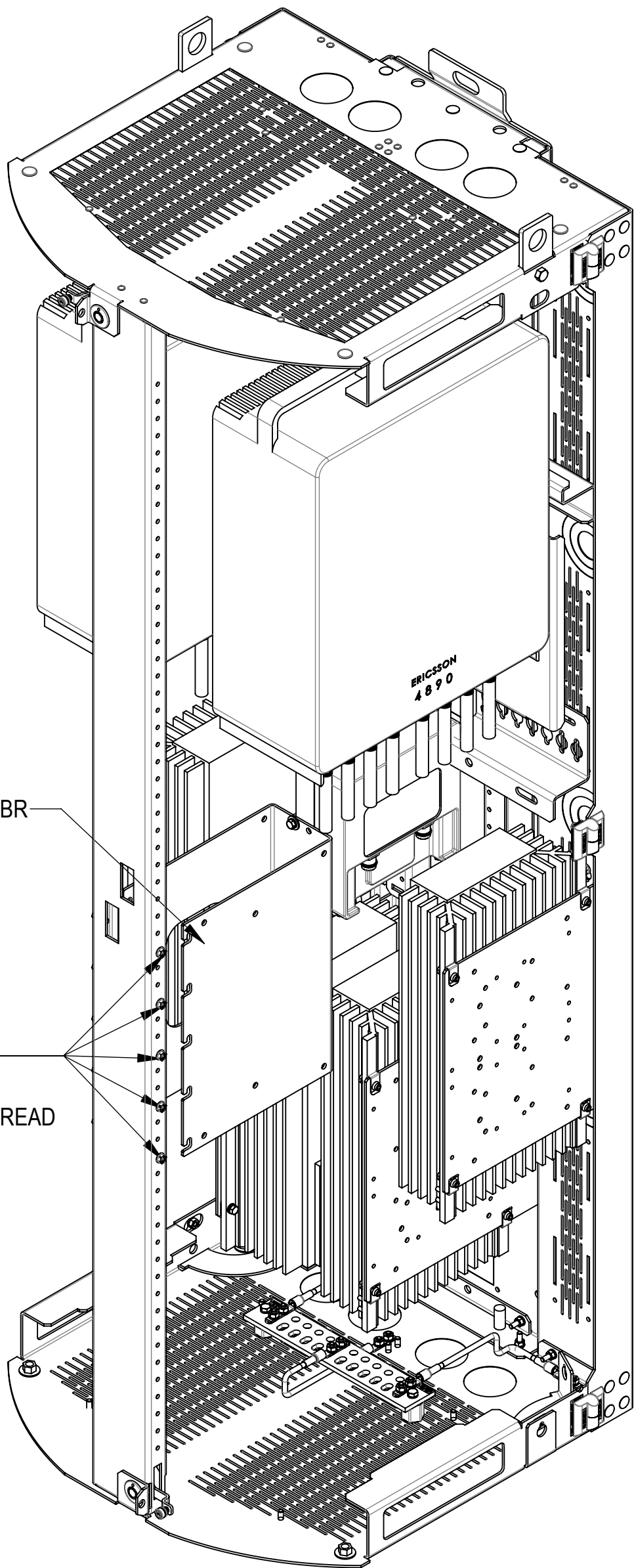

STEP 7

HANG THE BRACKET MTM1212-2000-BR WITH 220x or 440x ON THE M6 SCREWS (SELF TAPPING THREAD), TIGHTEN THEM DOWN AS SHOWN

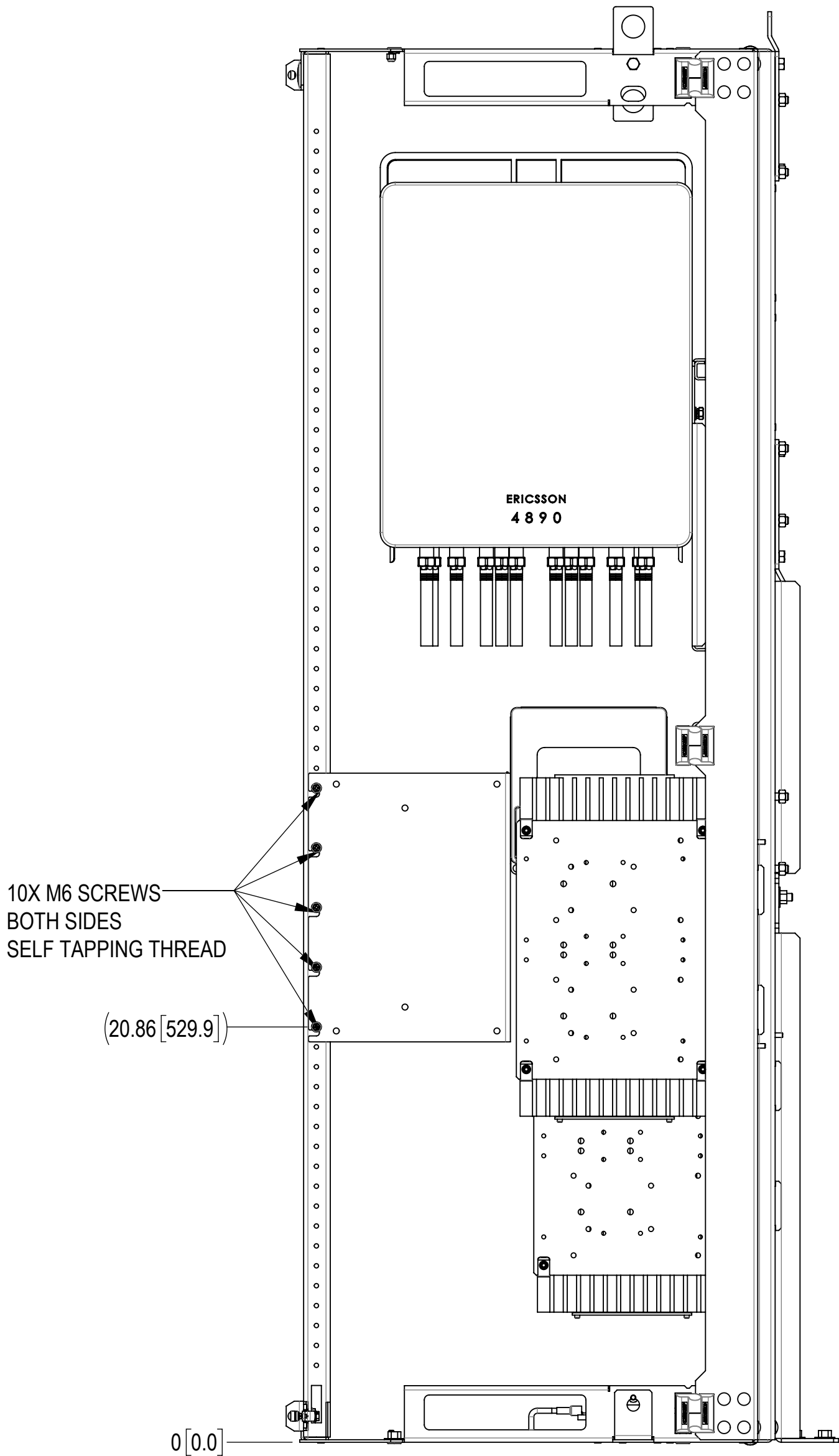

RIGHT VIEW  
M6 SCREWS LOCATION SHOWN  
(DOORS NOT SHOWN)



# Installation Instructions

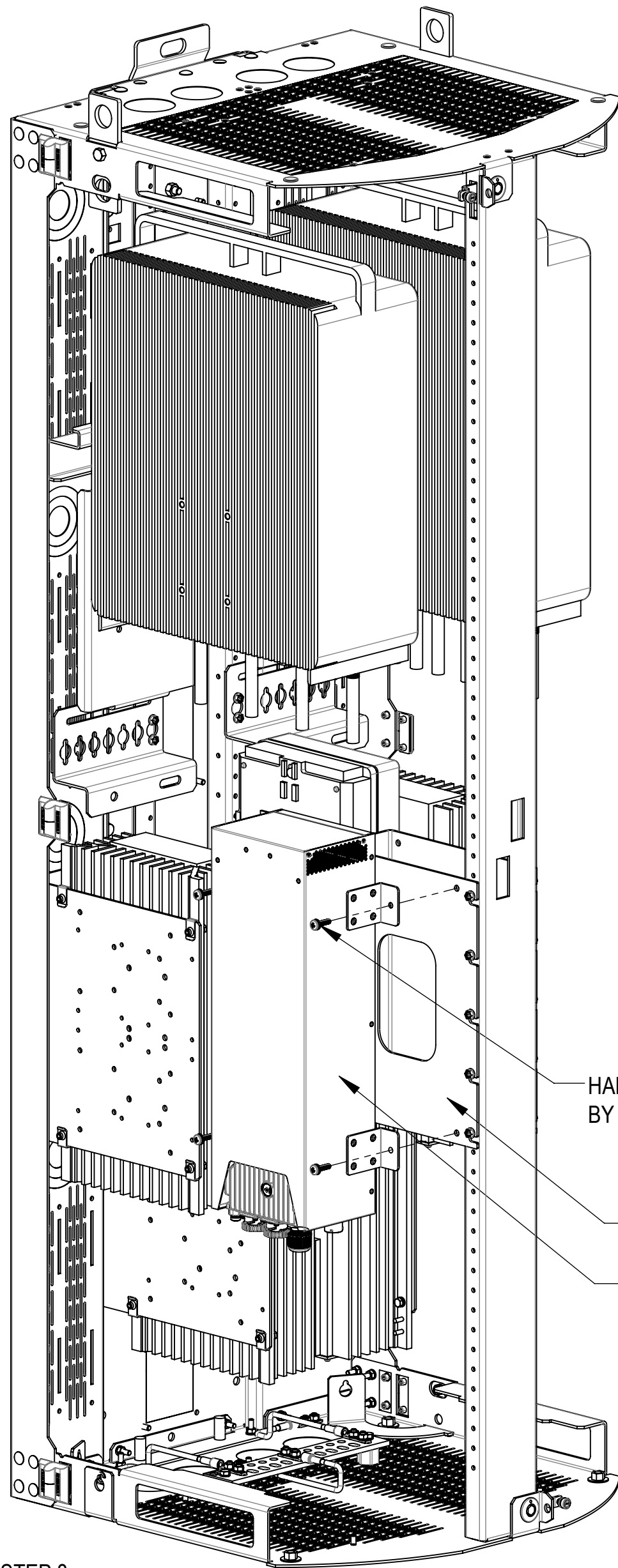

**STEP 8**  
INSTALL DC-AC INVERTER WITH HARDWARE SUPPLIED BY CUSTOMER

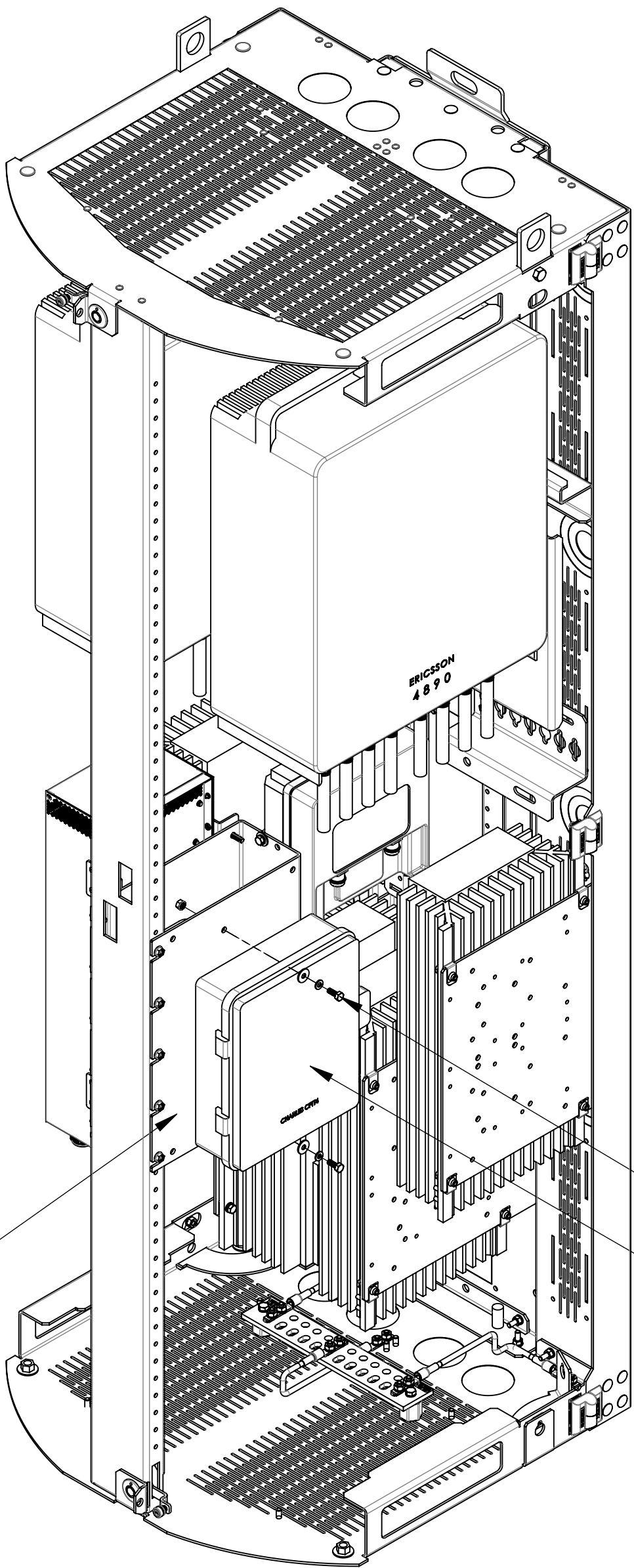

**STEP 9**  
INSTALL CHARLES CFTT4 FIBER BOX TO THE BRACKET MTM1212-2000-BR WITH 2 SETS OF M6 HEX BOLTS, M6 LOCK & FLAT WASHERS, 2EA M6 NUTS AS SHOWN.

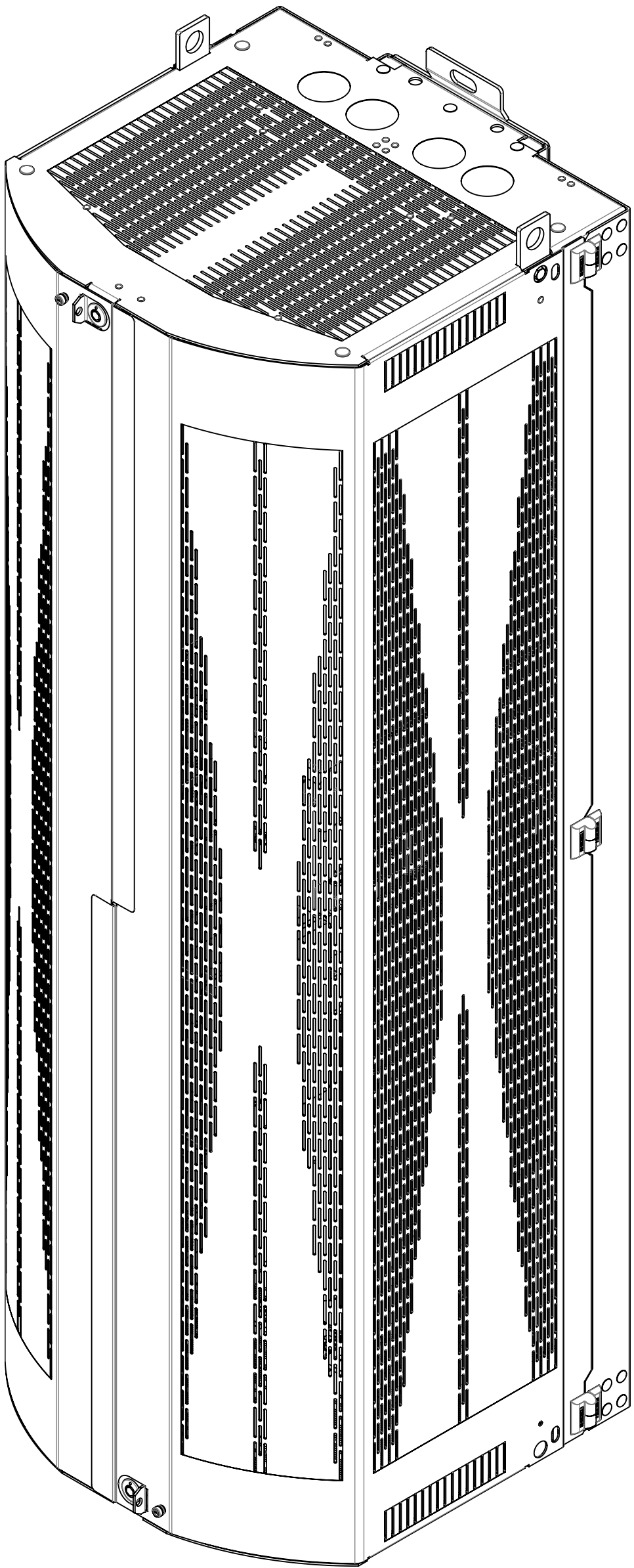

**STEP 10**  
CLOSE, OR RE-INSTALL AND CLOSE, DOORS