

660106617
Revision A / June 2025
commscope.com

Discrete Distribution Module (DDM) Panels

General

The CommScope® discrete distribution module (DDM) panels are available in a 24 port, flat or angled configuration.

The panel consists of a rack mounted base unit, rear cable management, loosely supplied jacks, labels for port numbering, hardware kit, hook-and-loop straps and troughs. Shielded panels have pre-assembled grounding hardware. Each panel mounts in a 19-inch (483mm) equipment rack with universal hole spacing.

Ordering information is listed below:

Material ID	Part No.	Description
760242560	CPP-6A-UDDM-SL-1U-24	Unshielded Discrete Distribution Module Panel Cat 6A, SL,1U, 24 port, Black
760242561	CPPA-6A-UDDM-SL-1U-24	Unshielded Angled Discrete Distribution Module Panel Cat 6A, SL, 1U,24 port, Black
760242562	CPP-6-UDDM-SL-1U-24	Unshielded Discrete Distribution Module Panel, Cat 6, SL, 1U, 24 port, Black
760242563	CPP-6A-SDDM-SL-1U-24	Shielded Discrete Distribution Module Panel, Cat 6A, SL, 1U, 24 port, Black
760242564	CPPA-6A-SDDM-SL-1U-24	Shielded Angled Discrete Distribution Module Panel, Cat 6A, SL, 1U, 24 port, Black

Note: sample product images are shown below for reference.

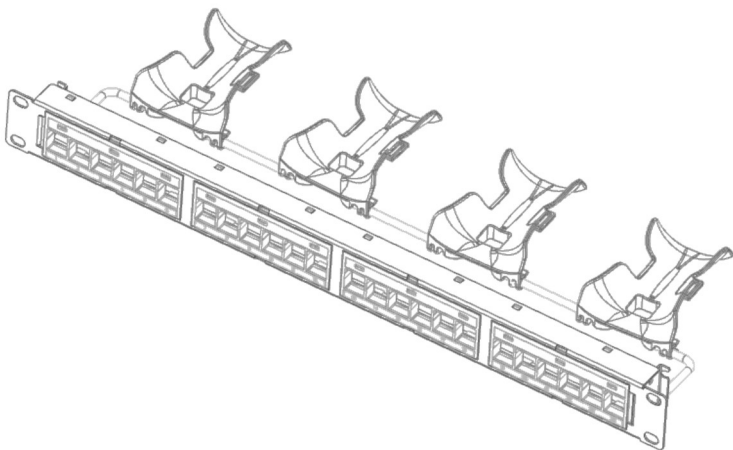

UDDM Flat Panel | CPP-UDDM-SL-1U-24

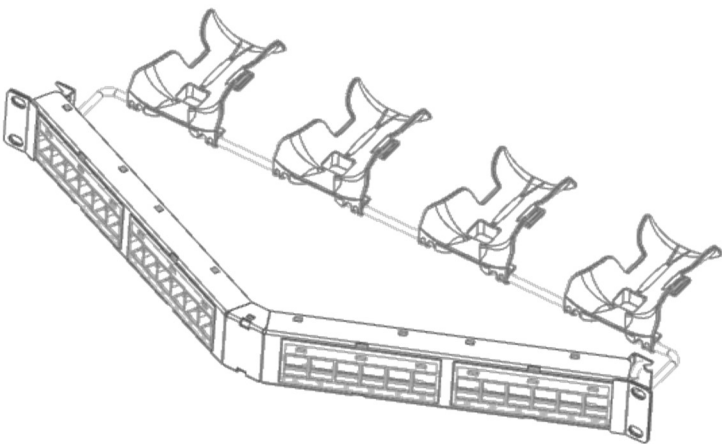

UDDM Angled Panel | CPPA-UDDM-SL-1U-24

Tools Required

- Phillips head screwdriver.
- Flat blade screwdriver, max 2.9mm dia.

Parts List

Verify parts against parts list below:

Quantity		Description
24-Port Flat Panel	24-Port Ang Panel	
1	—	24-port flat panel
—	1	24-port angled panel
1	1	P12-24 x ½" mounting screws kit
1	1	Label holder kit
1	1	Rear cable management
1	1	Hook and loop strap kit
24	24	Jacks
4	4	Troughs



WARNING – Important Safety Instructions

When using this product, the following basic safety precautions should be followed to reduce the risk of fire, electric shock, and injury to persons:

1. Never install communications wiring in wet locations unless it is designed for wet locations.
2. Never install this product during a lightning storm. There is a remote risk of electric shock.
3. Never touch uninsulated communication wiring or terminals unless the communication circuit has been disconnected at the network interface.
4. **Caution:** All wiring that connects to this equipment must meet applicable local and national building codes and network wiring standards for communication cable.

A. Installation of Panel

Step 1 – Mount Panel to Rack

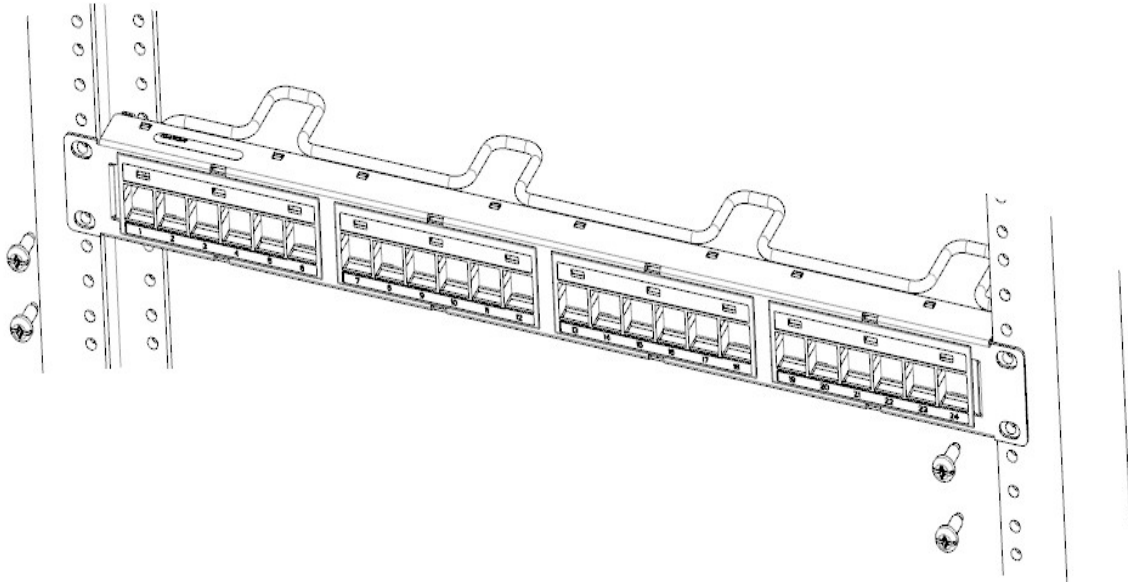

1. Mount panel to rack.

Step 2 – Assemble Rear Cable Management and Other Accessories

1. Attach rear cable management as shown and insert troughs. Insert hook-and-loop straps into the trough slot.

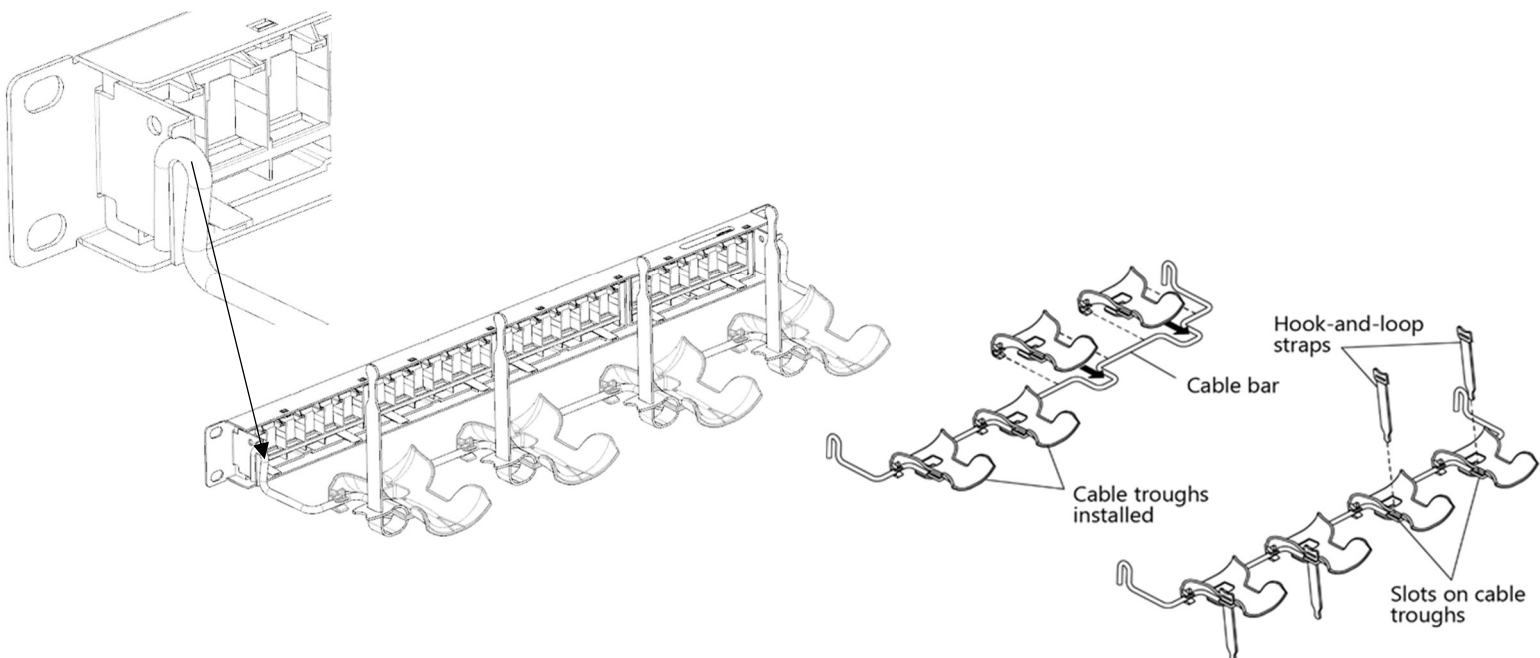

Step 3 – Populate Panel with Jacks and Connect Ground

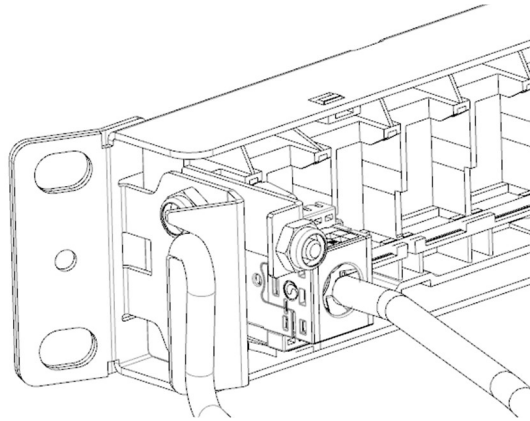

24-Port Panel

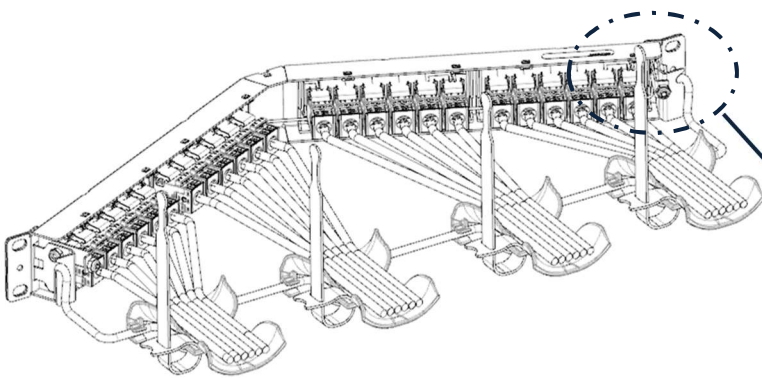

Angled Panel

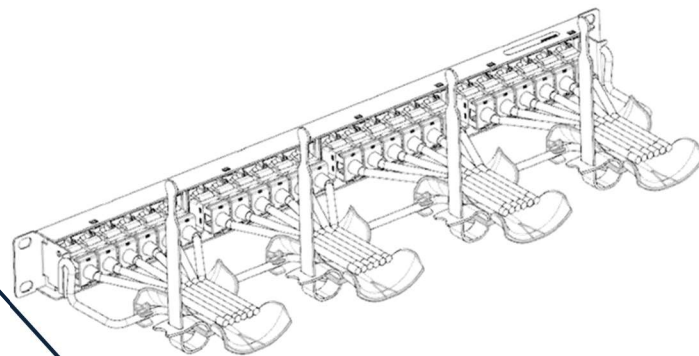

Flat Panel

1. Connect cables to jacks per instructions provided with the individual jacks.
2. Populate panel with jacks and route cabling as shown.

Note: Secure cables using the hook-and-loop straps provided.

3. For shielded panels only, use one of two grounding lug connections provided on rear of panel and lock nut to ground the panel per approved local practices. Tighten hex nut from 10-15 in-lb (1.1 to 1.6 N-m)

Panel Ground

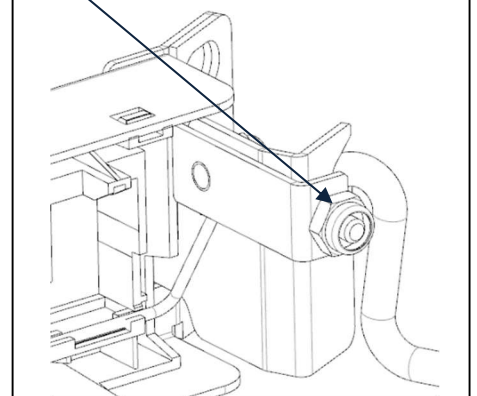

Step 4 – Attaching Information Labels

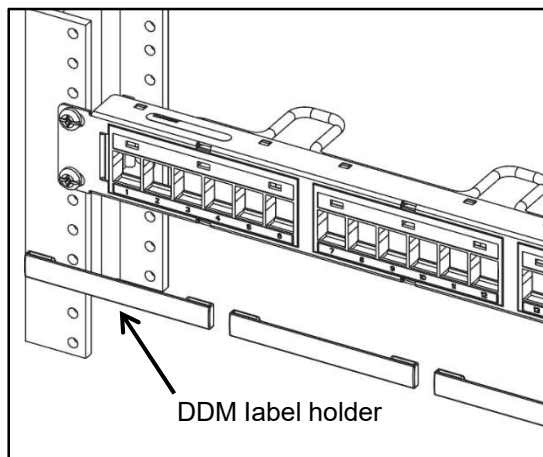

1. Enter information on the white information labels provided in label holder kits. Snap holders into panel modules and insert labels into label holders as shown in the above image.
2. To print a designation label go to <http://www.commscope.com/Resources/Labeling-Templates> and scroll down to “Copper Panels” and select the proper label template.

or

go to <https://www.commscope.com/> and search individual part number (material ID). Select the part number and scroll down to “documentation and downloads” section. In template section, select the required label size.

Note: Labeling website has two options for printing labels; letter size and A4 size.

B. To Remove a Jack from Panel

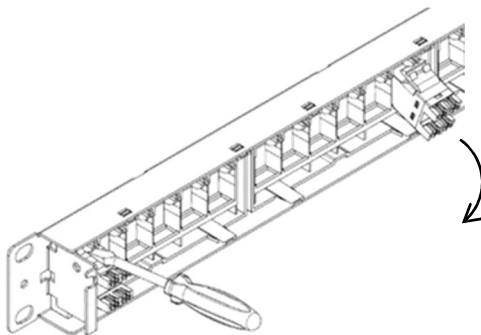

1. Insert a small, 2.9mm dia. max flat-blade screwdriver into the slot above the jack and rotate to release the latch.
2. Remove jack from rear of panel.
3. Note – rear cable management may need to be removed to enable access to the release slot on some jack positions.

Trade-marks

All trademarks identified by ® or ™ are registered trademarks or trademarks, respectively, of CommScope, Inc. This document is for planning purposes only and is not intended to modify or supplement any specifications or warranties relating to CommScope products or services. CommScope is committed to the highest standards of business integrity and environmental sustainability, with a number of CommScope's facilities across the globe certified in accordance with international standards, including ISO 9001, TL 9000, and ISO 14001.

Further information regarding CommScope's commitment can be found at:
<https://www.commscope.com/corporate-responsibility-and-sustainability/>.

Contact information

Visit our website or contact your local CommScope representative for more information.

For technical assistance, customer service, or to report any missing/damaged parts, visit us at:
<http://www.commscope.com/SupportCenter>

Or Contact PartnerPRO Network Partner <https://www.commscope.com/partners/>

This product may be covered by one or more U.S. patents or their foreign equivalents.
For patents, see www.cs-pat.com