

# L2TDM-PL



7-16 DIN Male Positive Lock for 3/8 in LDF2-50 cable

## Product Classification

Product Type	Wireless and radiating connector
Product Brand	HELIAX®
Product Series	LDF2-50

## General Specifications

Body Style	Straight
Cable Family	LDF2-50
Inner Contact Attachment Method	Captivated
Inner Contact Plating	Silver
Interface	7-16 DIN Male
Mounting Angle	Straight
Outer Contact Attachment Method	Ring-flare
Outer Contact Plating	Trimetal
Pressurizable	No

## Dimensions

Height	34.54 mm   1.36 in
Width	34.54 mm   1.36 in
Length	51.31 mm   2.02 in
Diameter	34.54 mm   1.36 in
Nominal Size	3/8 in

## Outline Drawing

# L2TDM-PL

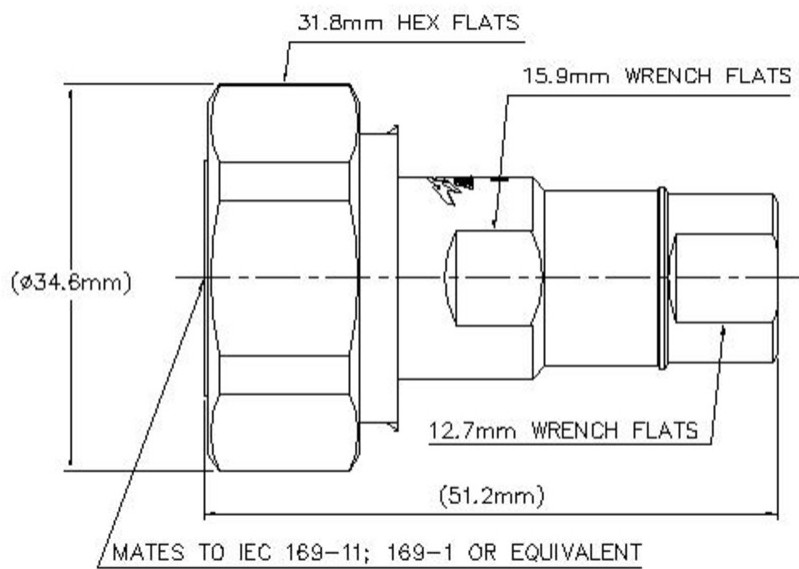

## Electrical Specifications

3rd Order IMD at Frequency	-107 dBm @ 910 MHz
3rd Order IMD Test Method	Two +43 dBm carriers
Insertion Loss Coefficient, typical	0.05
Average Power at Frequency	0.7 kW @ 900 MHz
Cable Impedance	50 ohm
Connector Impedance	50 ohm
dc Test Voltage	2500 V
Inner Contact Resistance, maximum	0.4 mOhm
Insulation Resistance, minimum	10000 MOhm
Operating Frequency Band	0 – 10000 MHz
Outer Contact Resistance, maximum	1.5 mOhm
Peak Power, maximum	15.6 kW
RF Operating Voltage, maximum (vrms)	894 V
Shielding Effectiveness	-110 dB

## VSWR/Return Loss

Frequency Band	VSWR	Return Loss (dB)
0-960 MHz	1.027	37.51

# L2TDM-PL

960–2200 MHz	1.058	31
2200–2700 MHz	1.065	30.04
2700–4000 MHz	1.083	27.99
4000–6000 MHz	1.089	27.41
6000–8000 MHz	1.089	27.41
8000–10000 MHz	1.36	16.5

## Mechanical Specifications

Attachment Durability	25 cycles
Connector Retention Tensile Force	671.68 N   151 lbf
Connector Retention Torque	2.7 N-m   23.897 in lb
Coupling Nut Proof Torque	35 N-m   309.776 in lb
Coupling Nut Retention Force	1000 N   224.81 lbf
Coupling Nut Retention Force Method	MIL-C-39012C-3.25, 4.6.22
Insertion Force	199.99 N   44.96 lbf
Insertion Force Method	IEC 61169-1:15.2.4
Interface Durability	500 cycles
Interface Durability Method	IEC 61169-4:17
Mechanical Shock Test Method	IEC 60068-2-27

## Environmental Specifications

Operating Temperature	-55 °C to +85 °C (-67 °F to +185 °F)
Storage Temperature	-65 °C to +125 °C (-85 °F to +257 °F)
Attenuation, Ambient Temperature	20 °C   68 °F
Average Power, Ambient Temperature	40 °C   104 °F
Average Power, Inner Conductor Temperature	100 °C   212 °F
Corrosion Test Method	IEC 60068-2-11
Immersion Depth	1 m
Immersion Test Mating	Mated
Immersion Test Method	IEC 60529:2001, IP68
Moisture Resistance Test Method	IEC 60068-2-3
Thermal Shock Test Method	IEC 60068-2-14
Vibration Test Method	IEC 60068-2-6

# L2TDM-PL

---

## Packaging and Weights

**Weight, net** 102.12 g | 0.225 lb

## Regulatory Compliance/Certifications

Agency	Classification
ISO 9001:2015	Designed, manufactured and/or distributed under this quality management system

## \* Footnotes

**Insertion Loss Coefficient, typical** 0.05v~freq (GHz) (not applicable for elliptical waveguide)

**Immersion Depth** Immersion at specified depth for 24 hours