

EQ-P1220-EP-LP

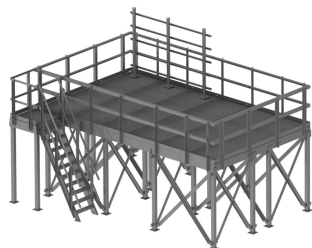

Equipment Platform Elevated Kit, 12 ft x 20 ft plus landing with Stairs, Handrail, & H-Frame for equipment mounting

Product Classification

Product Type Equipment platform system

General Specifications

Legs, quantity 18

Dimensions

Width 6096 mm | 240 in

Length 3,657.6 mm | 144 in

Material Specifications

Material Type Hot dip galvanized steel

Mechanical Specifications

Load Capacity Up to 10,000 lb (4536 kg) loading

Packaging and Weights

Included Frame | Grating | Hardware | Legs | Rail | Steps

Packaging quantity 1

Weight, net 4,043.9 kg | 8,915.263 lb